

Talon FLEX

openGear Chassis

NEW
2024

The FLEX chassis accepts all Osprey openGear cards. It has been designed for lower density rackmount and desktop applications, the included mounting kit supports desktop, rackmount and wall mount applications.

FEATURES:

- Genlock (for Decoder Applications)
- GigE Ethernet
- Customizable Display (any 3 of below options can be displayed simultaneously)
 - Channel Status
 - Input Video Resolution and Frame Rate
 - IP Address
 - MAC Address
 - Device Name
 - VPN Status
 - Firmware Version
 - Serial Number
- Customizable LEDs
 - Signal Lock
 - Channel Status
 - VPN Status
 - Ethernet Link
- Action Button
 - Start/Stop
 - Reset
- Locking 12VDC Power Jack

SPECIFICATIONS:

- Dimensions in mm: 335 (l) x 103 (w) x 30 (h)
- Weight: 350g



Included Mounting Kit:

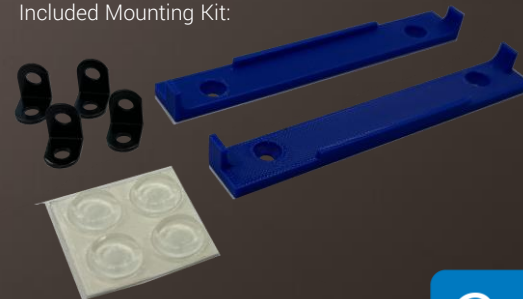

1U Rack Shelf Application

Osprey[®]
Video